

Desktop

- keeping "show prefs" tab/button on top of / in front of prefs panel

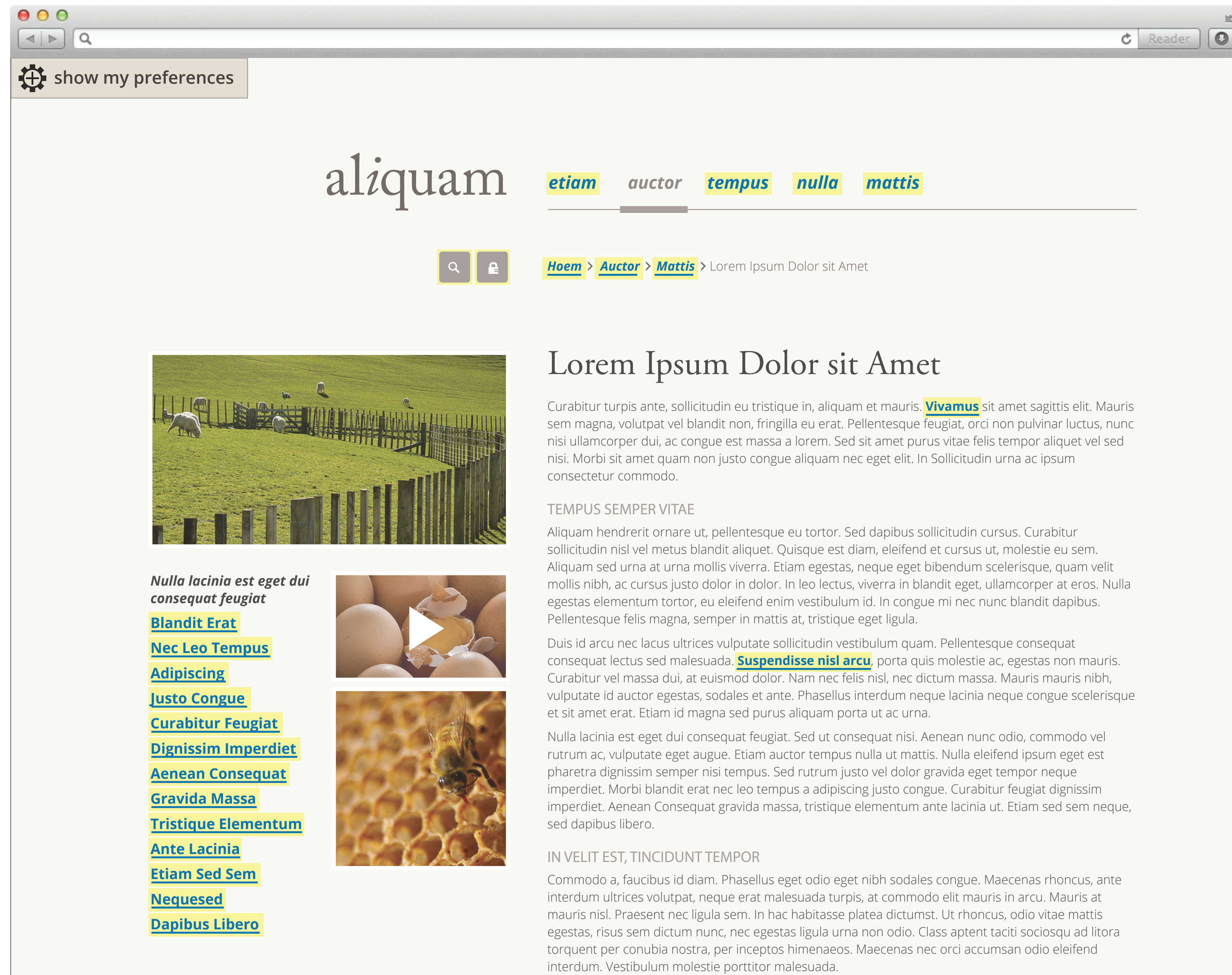

tab order: show my prefs --> hide my prefs --> reset all --> first panel (text size) adjuster -----> into content?

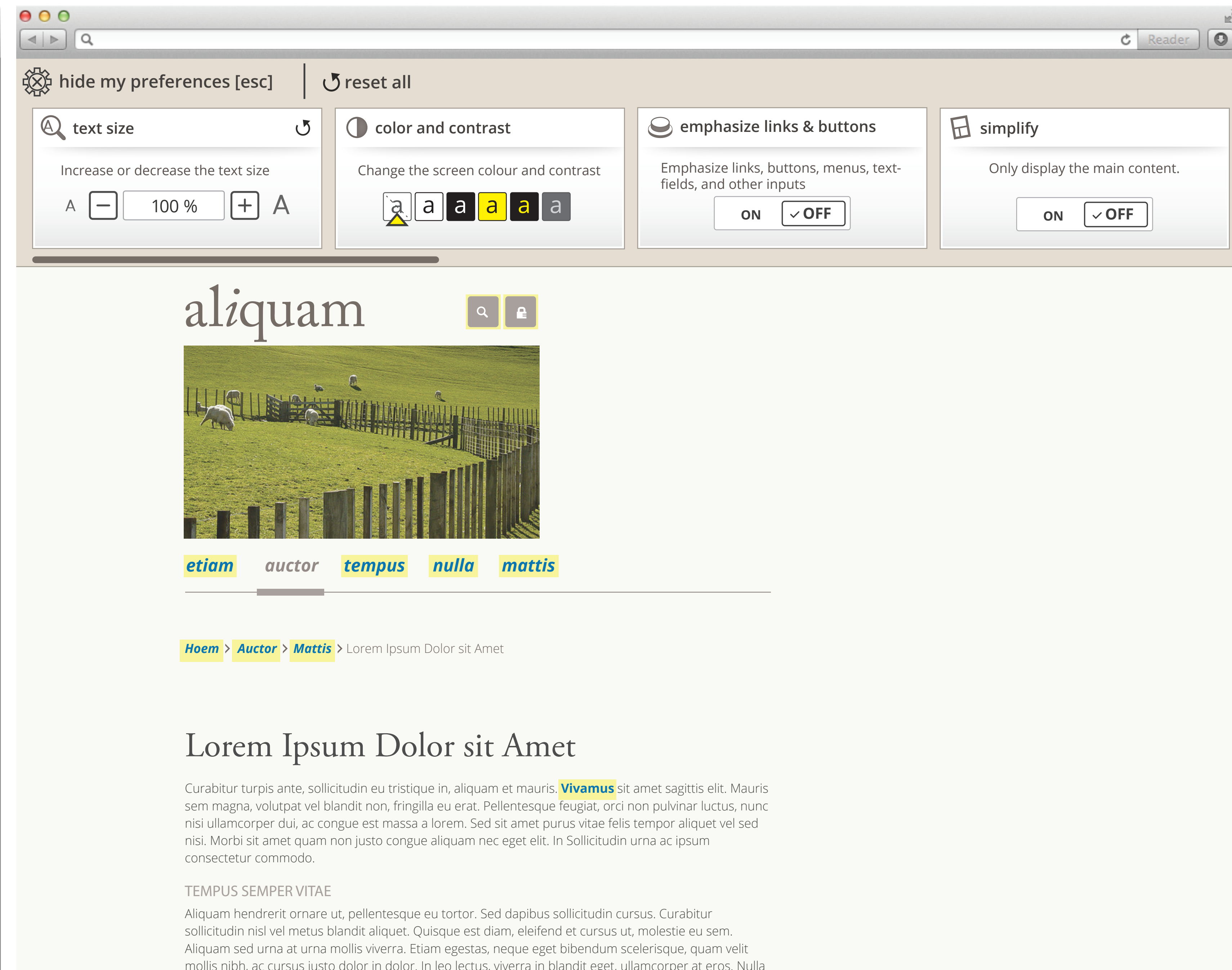

Provides more info about the preference (descriptions as shown in desktop view)

Mobile

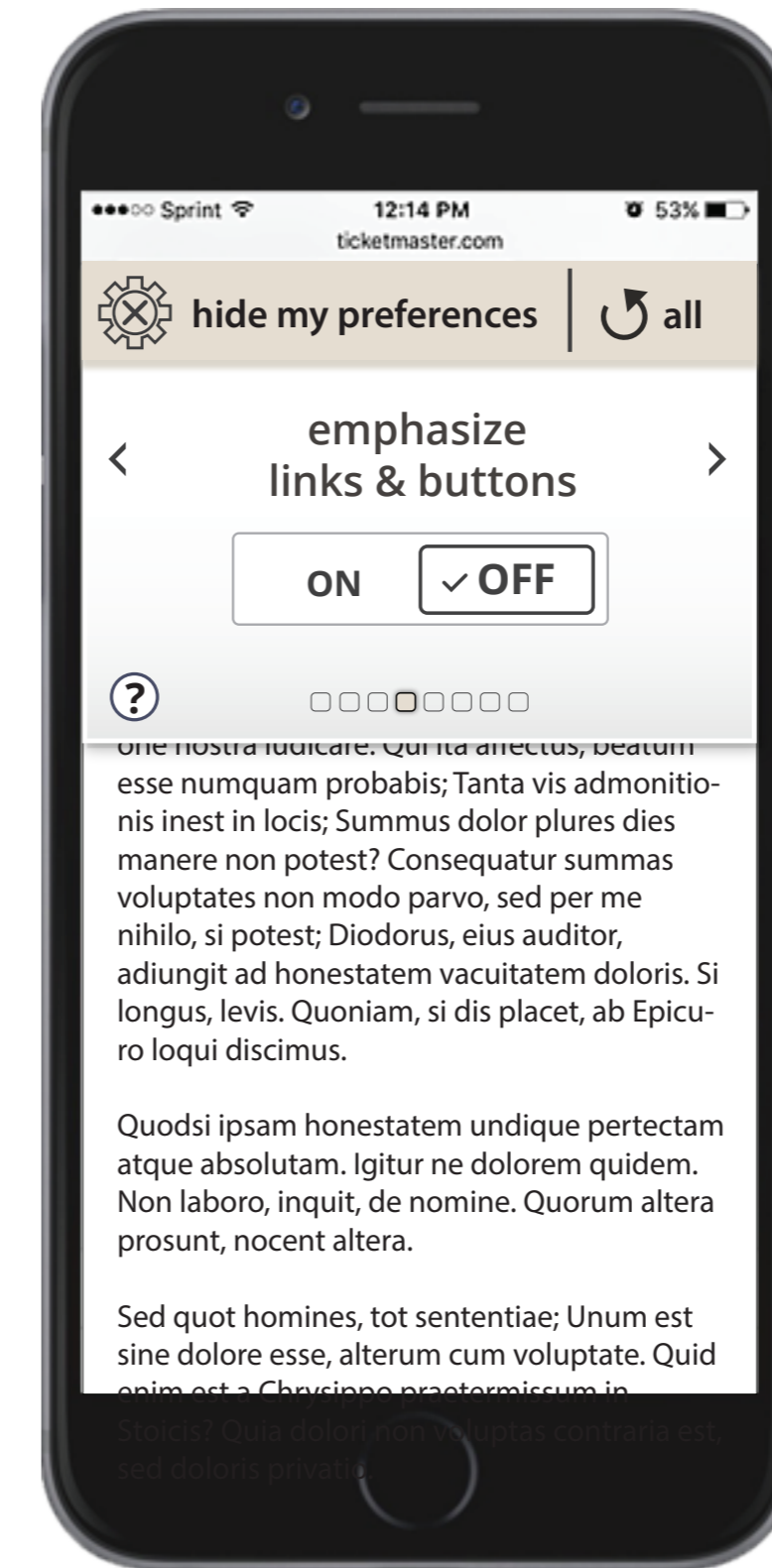
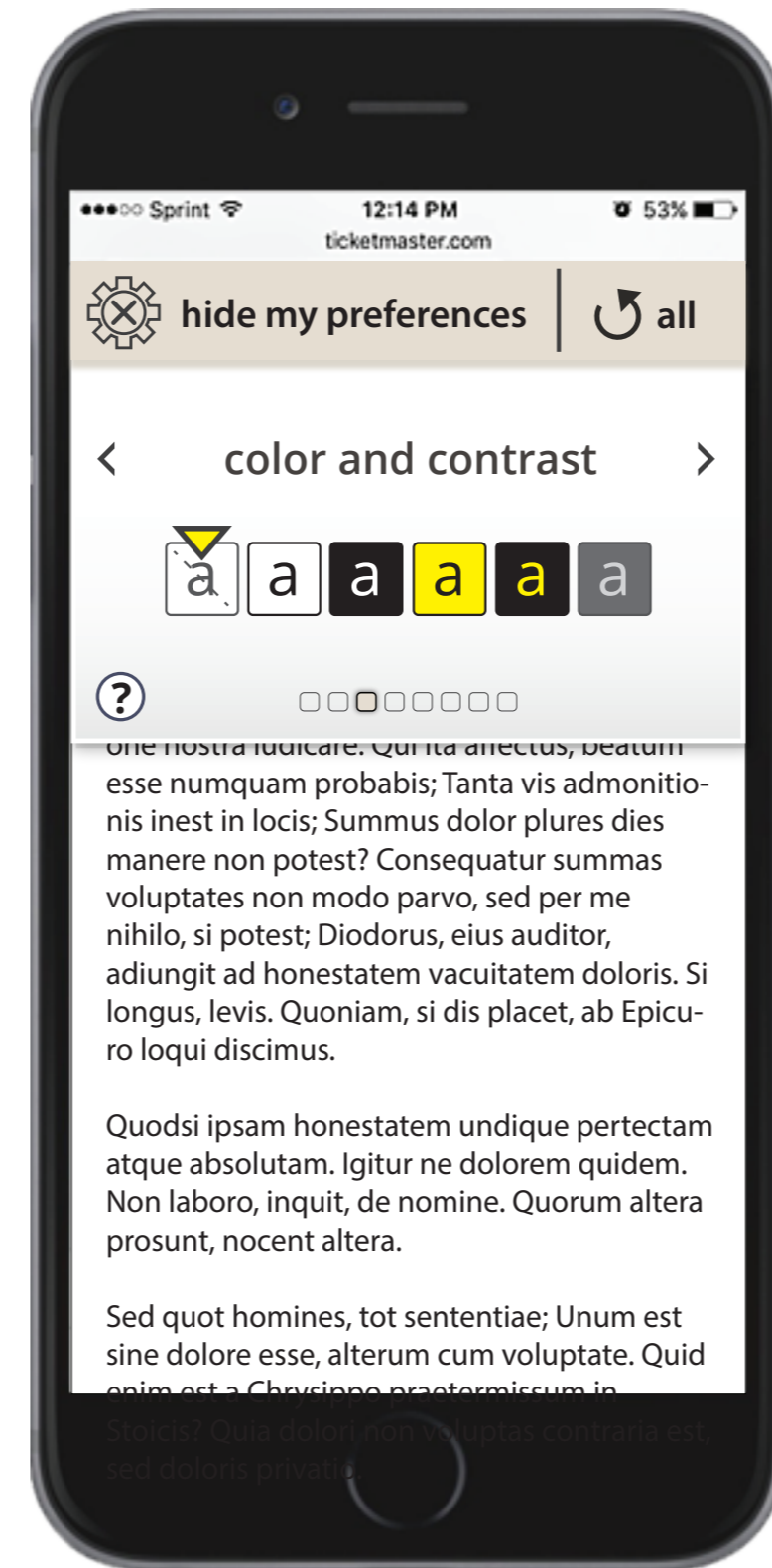
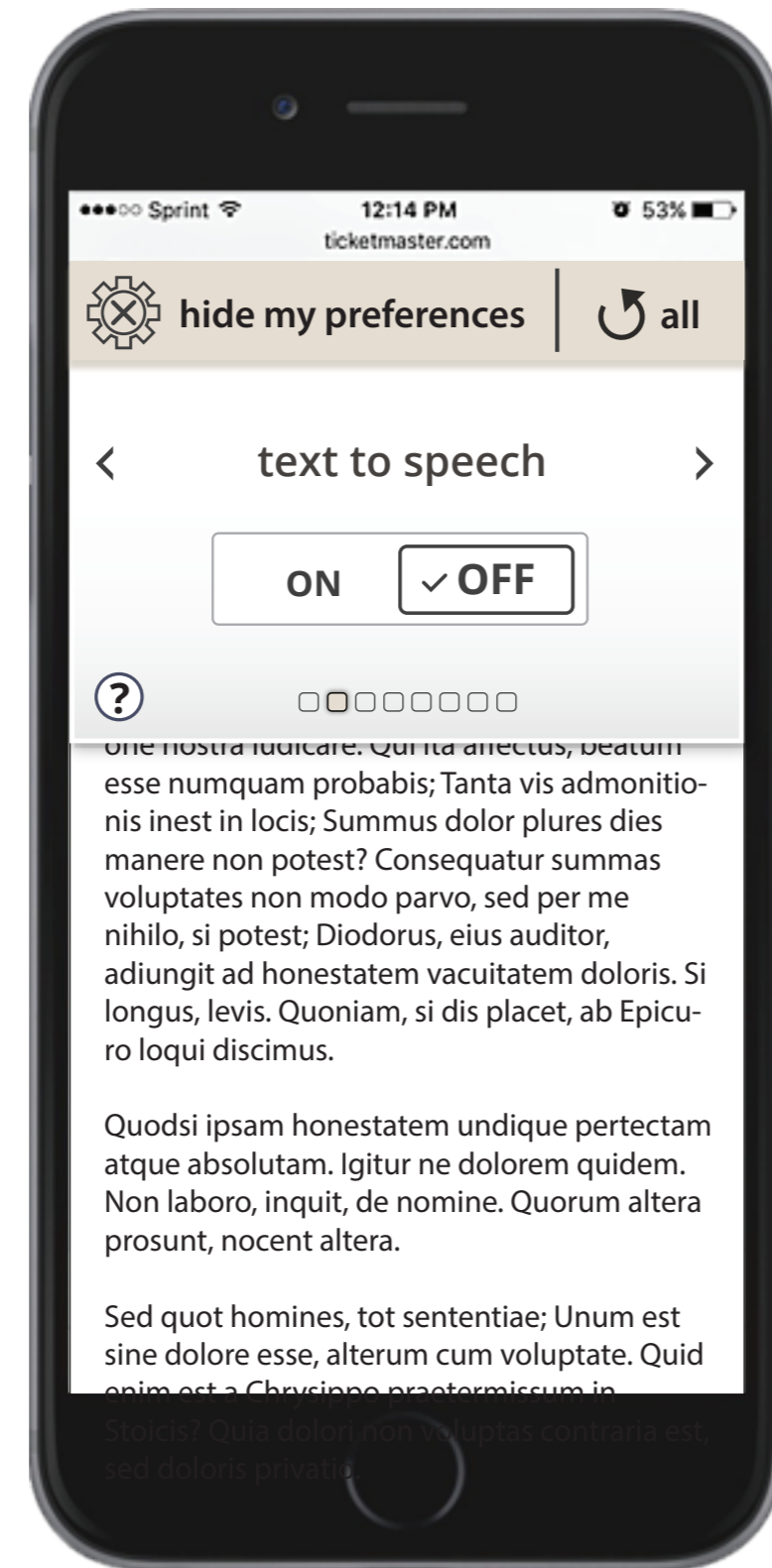
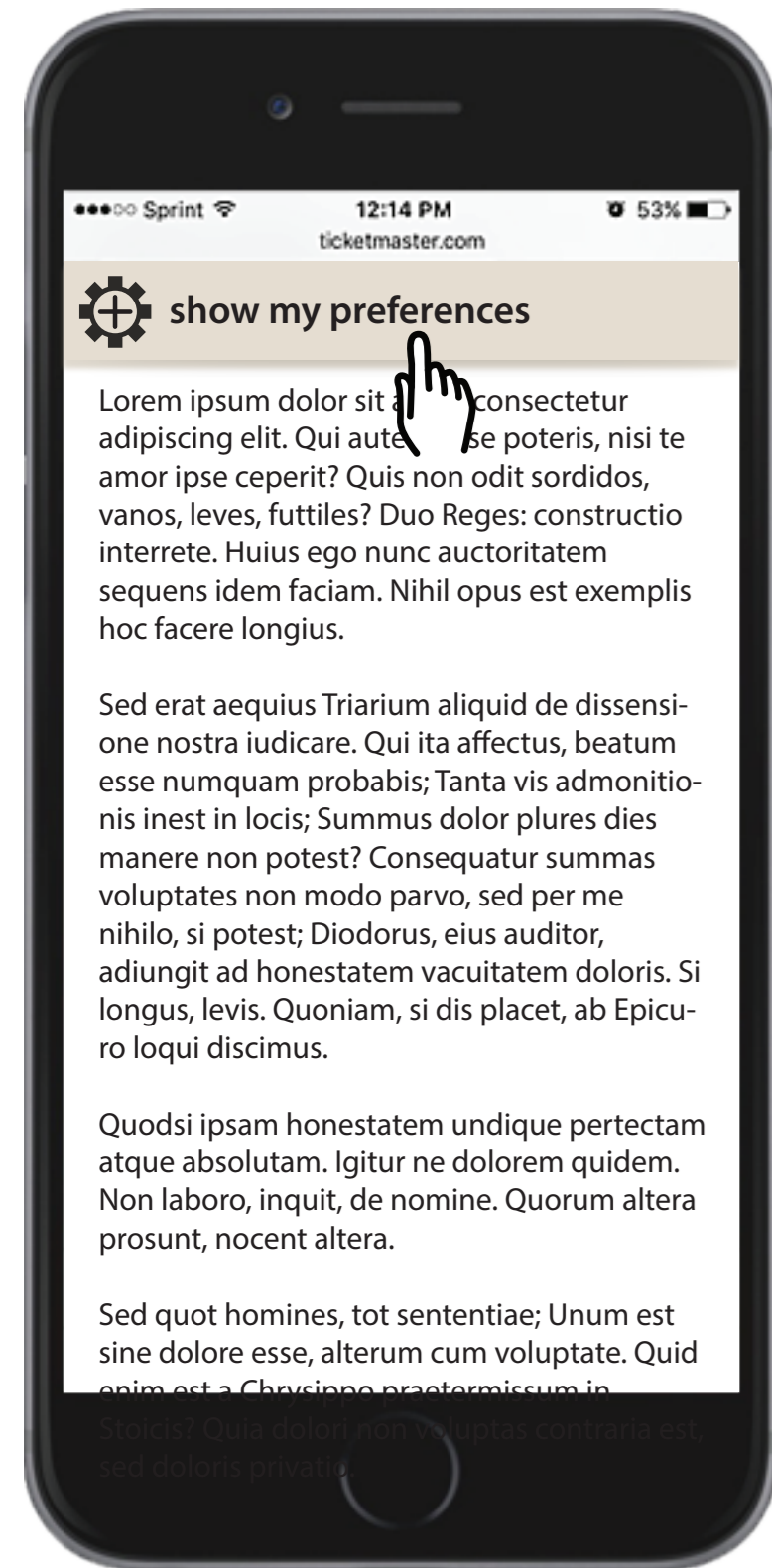

individual reset button appears in bottom right corner (for numerical steppers only)

Mobile - widget/header placement

preferences widget incorporated into site menu - example

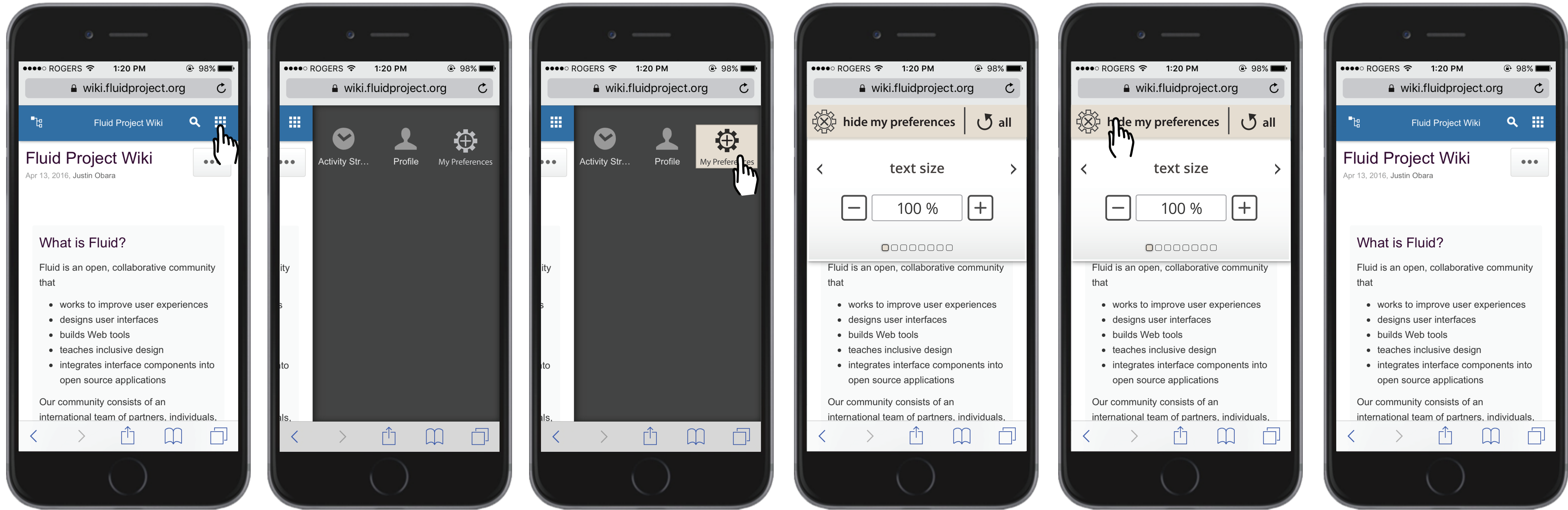

show widget / header at top of page only

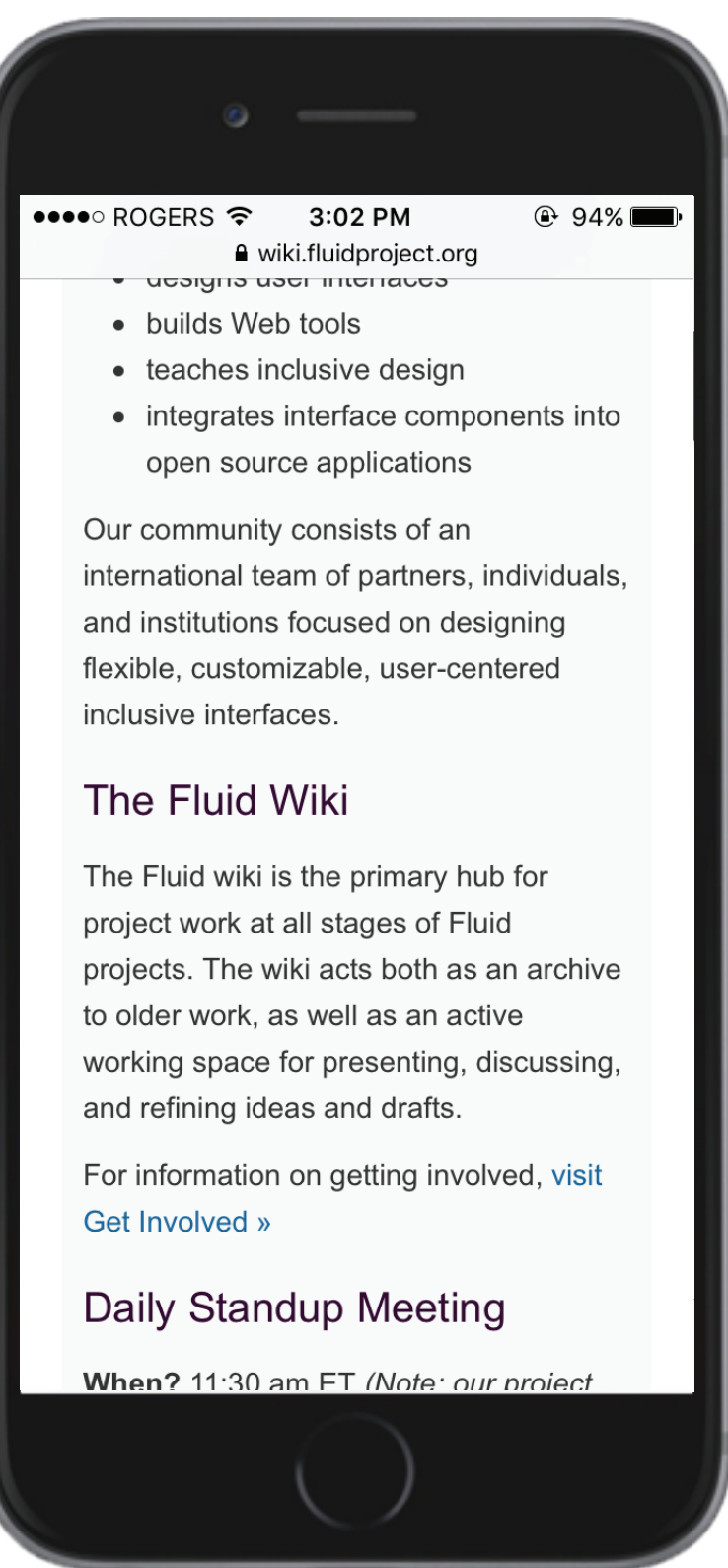
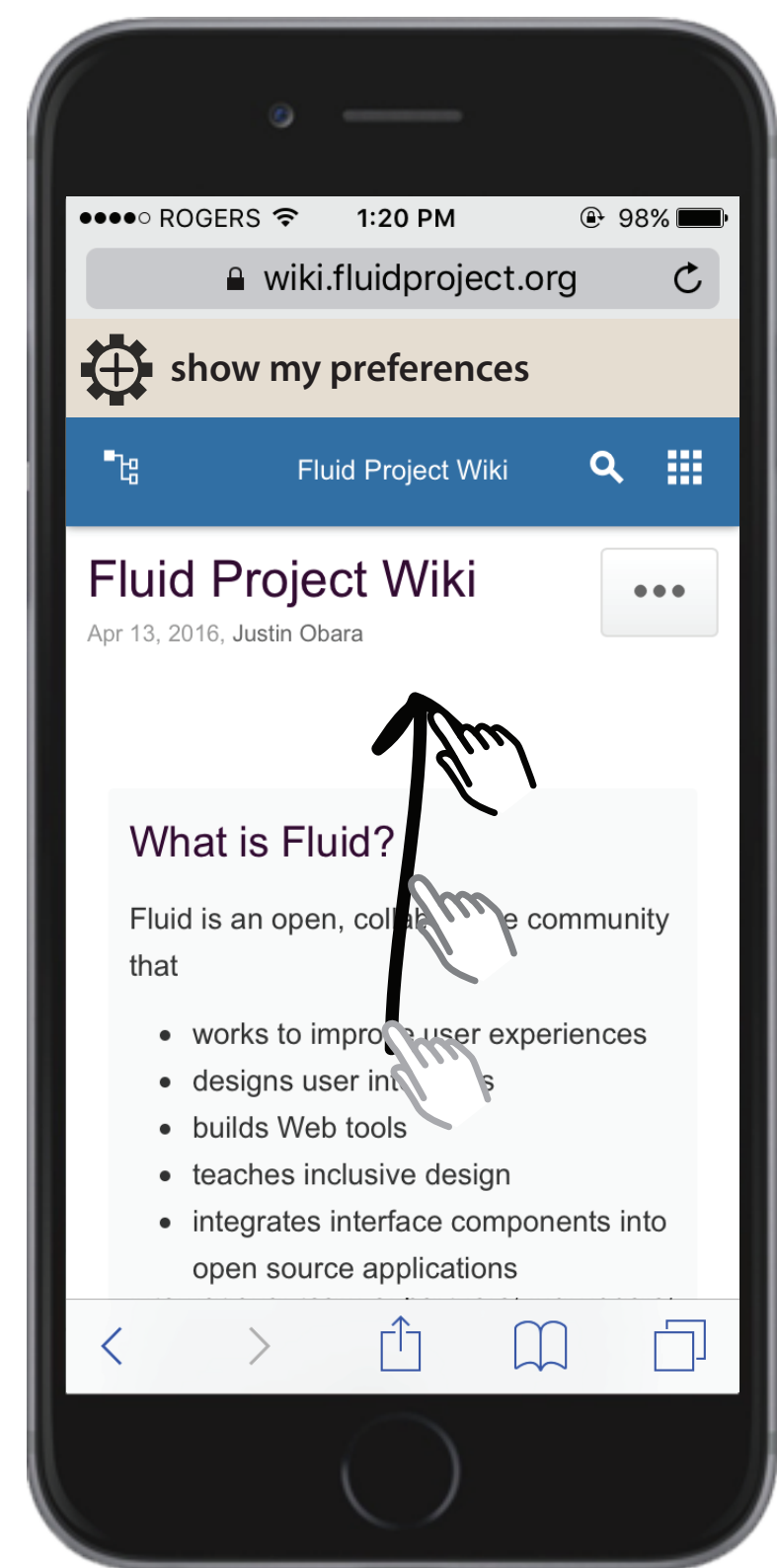

incorporate widget into site header

